



**PARAMOUNT LAND**

Building homes and people with heart

# SUCCESS STORIES



**MAGGIORE**

*Square*

1 + 2



**MAGGIORE**

*Grande*

1 + 2

**STRATEGIC BUSINESS PARK  
IN GADING SERPONG**



# MAGGIORE

*Junction*

**Paramount Land –  
lebih dari 20 cluster  
terhuni**

**Summarecon –  
lebih dari 17  
cluster terhuni**

**BSD City – lebih  
dari 4 cluster  
besar terhuni**



- **Pusat perbelanjaan**
- **Pusat kuliner**
- **Apartemen**
- **Sekolah ternama**
- **Perkantoran**

**Dilalui lebih dari  
6.500 mobil per jam**

# **KAWASAN MAGGIORE**

---

**Trendsetter**

---

**Crowd Puller**

---

**Destination**

---

**Pedestrian Oriented**

---

**New Ambience**

---





**PARAMOUNT LAND**  
Building homes and people with heart



**MAGGIORE**  
Swastika







**PARAMOUNT LAND**  
Building homes and people with heart



**MAGGIORE**  
Swastika







**PARAMOUNT LAND**  
Building homes and people with heart



**MAGGIORE**  
Lifestyle







**PARAMOUNT LAND**  
Building homes and people with heart



**MAGGIORE**  
Lifestyle







**PARAMOUNT LAND**  
Building homes and people with them



**MAGGIORE**  
Solutions







**PARAMOUNT LAND**  
Building homes and people with heart



**MAGGIORE**  
Swastika







**PARAMOUNT LAND**

Building homes and people with them



**MAGGIORE**

Swastika



# Tipe 4,5x14, 15, 17







PARAMOUNT LAND  
Building homes and people with them



MAGGIORE  
Swadine

# Tipe 4,5x14 (2 Lantai)



DENAH LANTAI 1 ( $\pm 0.00$ )



DENAH LANTAI 2 ( $\pm 4.00$ )

# Tipe 4,5x12 (3 Lantai)

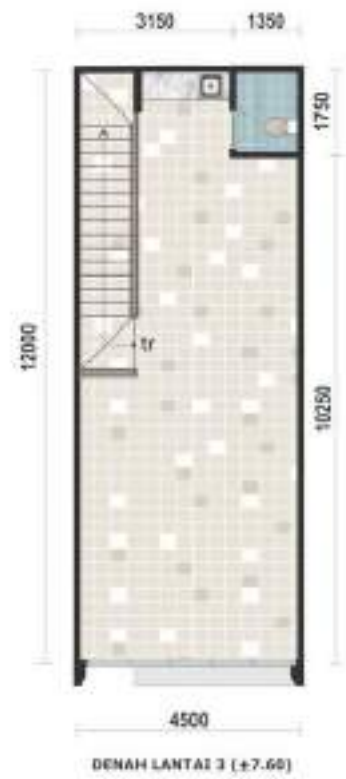
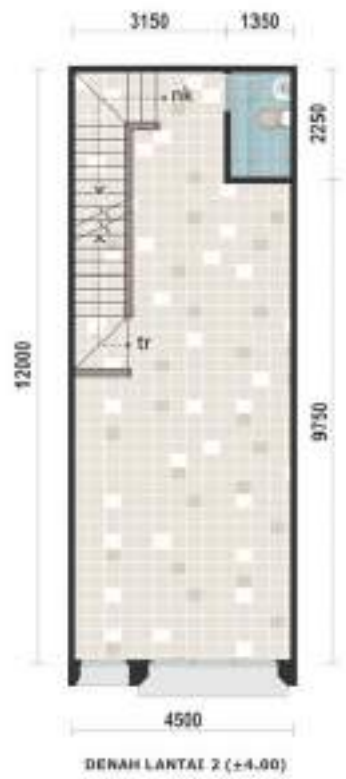
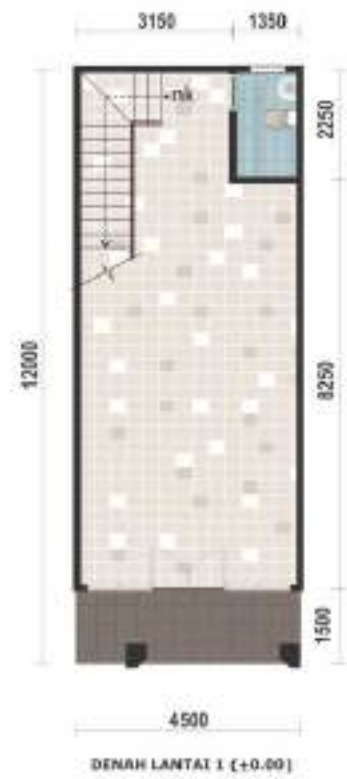



# Tipe 5 x 12



# Tipe 5 x 11





# Tipe 5,5 x 12

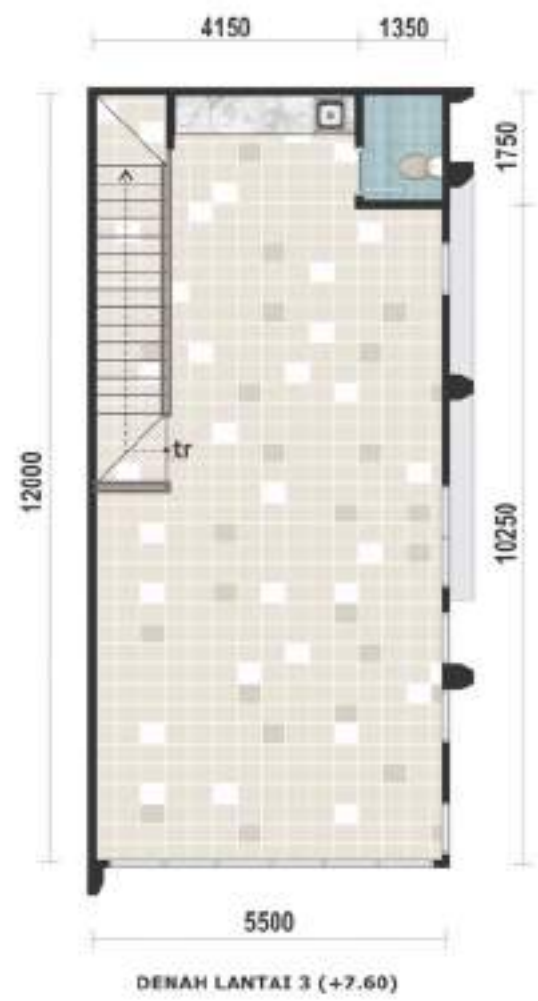
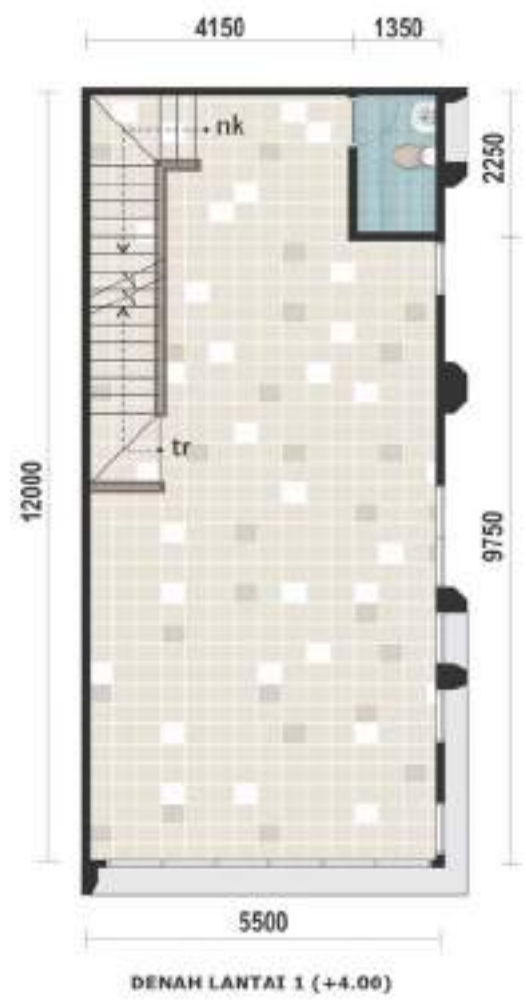
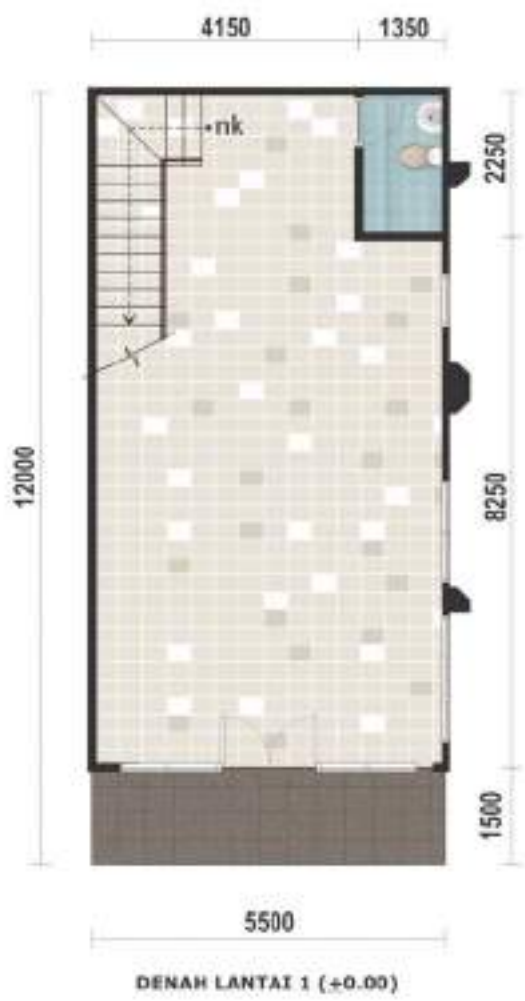

# Tipe 5,5 x 11





# Tipe 6,5 x 15



# Tipe 6,5 x 12





# Tipe 6,5 x 11





# FACADE





# FACADE



**FACADE**





# FACADE



**FACADE**





**FACADE**



**PARAMOUNT LAND**  
Building homes and people with them



**MAGGIORE**  
Swastika



**FACADE**





**PARAMOUNT LAND**  
Building homes and people with them



**FACADE**



**FACADE**



## DENAH POTONGAN

4.5x14 - 17

3 Lantai



## DENAH POTONGAN

4.5x12

3 Lantai





## DENAH POTONGAN

4.5x14

2 Lantai



## DENAH POTONGAN

5x11

3 Lantai







PARAMOUNT LAND  
Building homes and people with heart



# SITE PLAN



**MAGGIORE JUNCTION**

|             |                       |                       |             |             |
|-------------|-----------------------|-----------------------|-------------|-------------|
| Type 6.0x11 | Type 6.0x16 (2 Level) | Type 6.0x16 (3 Level) | Type 6.0x19 | Type 6.0x17 |
| Type 6.0x11 | Type 6.0x16           | Type 6.0x16           | Type 6.0x19 | Type 6.0x17 |
| Type 6.0x11 | Type 6.0x12           | Type 6.0x19           | Type 6.0x19 | Type 6.0x17 |



Jl. Maggiore Boulevard - ROW 30

## ■ SPESIFIKASI TEKNIS

**Pondasi** : Tiang pancang (mini pile) • **Struktur kolom, balok, dak, sloof, ring balok, tangga** : Beton bertulang • **Rangka atap** : Rangka baja ringan (zincalum) • **Penutup atap** : Atap metal (zincalum) + aluminium foil • **Lantai utama** : Homogenous tile 60x60 • **Lantai teras** : Keramik 40x40 • **Lantai KM/WC** : Keramik 30x30 • **Dinding KM/WC** : Keramik 30x60 • **Dinding Dalam** : Bata ringan diplester + aci • **Dinding luar** : Window wall, Bata ringan diplester finish cat weather resistant acrylic emulsion paint, aluminium composite panel





- **Plafond dalam** : Gypsumboard
- **Plafond luar** : Gypsum water resistant
- **Sanitary** : ex. Toto
- **Pintu/Jendela utama** : Kaca clear frame aluminium fin powder coating
- **Pintu/Jendela lainnya** : Kaca clear frame aluminium fin powder coating
- **Pintu KM/WC** : Panel dan kusen UPVC
- **Listrik** : Suplai PLN daya 3500 VA (2 Lantai) dan 5500 VA (3 Lantai)
- **Telepon** : Instalasi kabel
- **Air bersih** : Suplai perumdam + toren
- **Air Kotor** : Septictank